

# FIAT

## Hidromekanik Direksiyon Sistemleri

Model : 55-46



## Hydromechanic Steering Systems

Uygulana Modeller / Applications Models

55/46 - 55/56 - 60/56

Üç Silindir Traktör Tipleri İçin Uygundur.  
It's Able To Kind Of Three Cylinder Tractor.

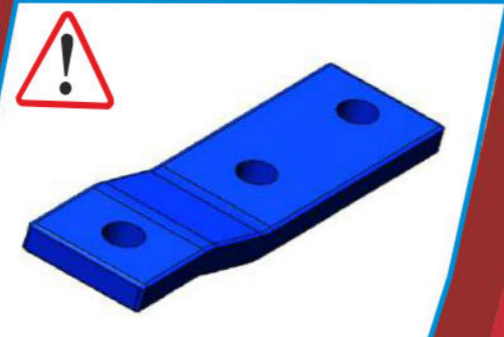

## FIAT 55/46-55/56-60/56 DİREKSİYON SETİ (3 SİLİNDİR)

SİPARİŞ KODU: HM-55/46-362

3  
SİLİNDİR

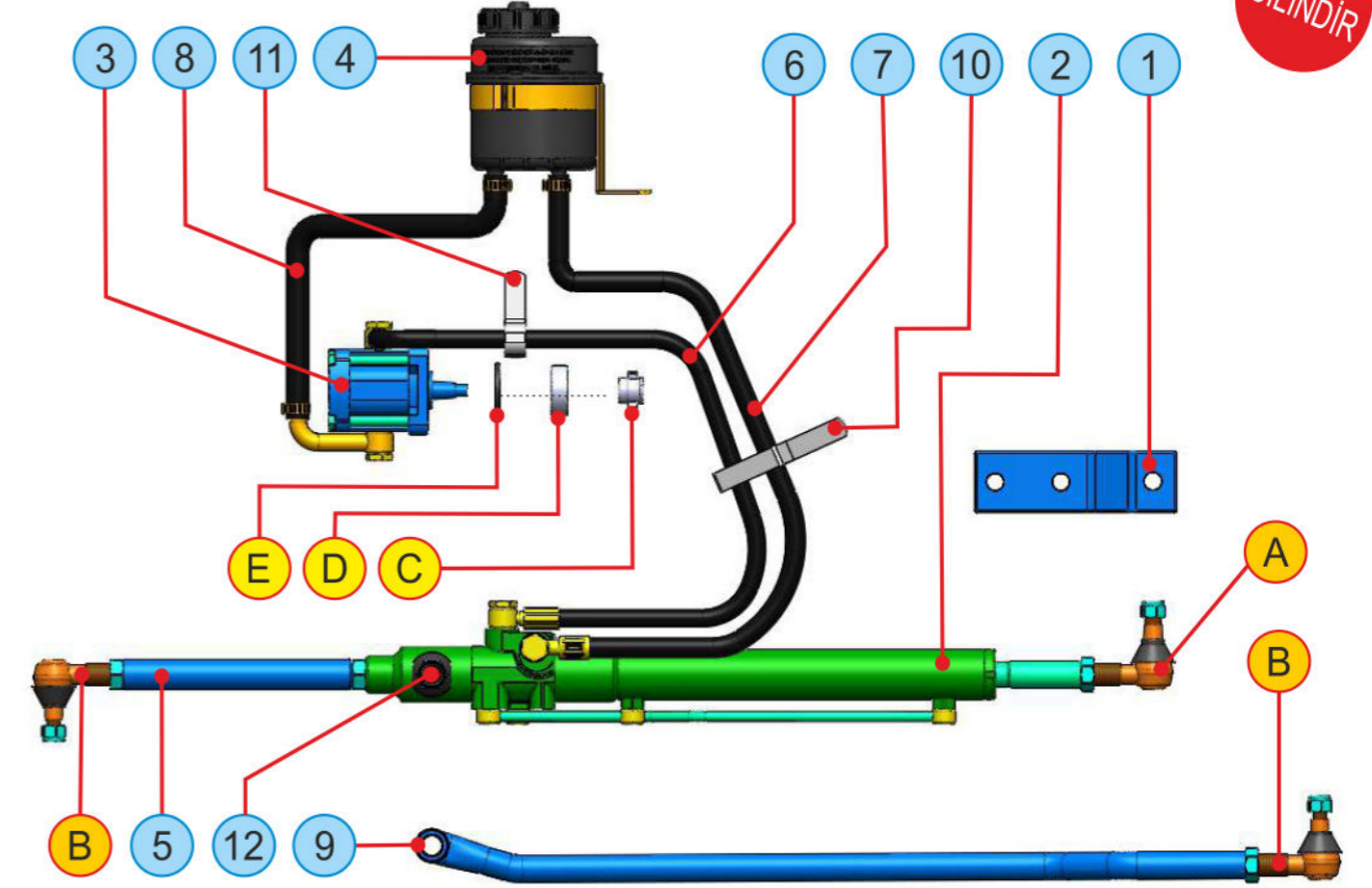

Nu	Parça Adı	No	Name of item	Kodu / Code
1	Bağlantı Braketi	1	Linkage Bracket	Kİ-BRK-55/46
2	Valf ve Piston Takımı	2	Steering Cylinder and Valve Kit	LT-362
3	Direksiyon pompası	3	Steering Pump	1PA-A12-CB28/022
4	Yağ Deposu (Komple)	4	Oil Tank ( Complete )	YD-FORD-SON
5	Ara Uzatma	5	Lif Extension	Kİ-AU-55/46
6	Basınç Hortumu 3/8 R.1 A.T.	6	Pressure Hose 3/8 R.1 A.T.	Kİ-65/46-BH
7	Tahliye Hortumu 1/2 R.6	7	Unloading Hose 1/2 R.6	Kİ-TH-085
8	Giriş Hortumu 5/8 R.6	8	Inlet Hose 5/8 R.6	5/8-075
9	Rot Kolu Borusu	9	Pipe For Steering Arm	Kİ-011-55/46
10	Hortum Sabitleme Laması	10	Clamp of Hose	Kİ-HSL-480
11	Hortum Sabitleme Kancası	11	Clamp of Hose Hooked	Kİ-HSK-480
12	Kumanda Kolu	12	Joystick	YP-KK-009
A	Rot Başı	A	Rot Head	DA-ROT-MF
B	Rot Başı	B	Rot Head	DA-ROT-55/46
C	Kavrama Maşonu İç	C	Clutch Sleeve In	DA-KMİ-070
D	Kavrama Maşonu Dış	D	Clutch Sleeve Out	DA-KMD-070
E	Ortalama Pulu	E	Average Flake	DA-OP-069